



## 7500 Series Self Adjusting Solid Installation Guide

Any questions please call 1-800-257-1243

### Installation Instructions

- Be sure O-ring is seated properly on inboard of seal. Orient seal with O-ring facing the bulkhead and then carefully slip housing over the shaft and seat it flush against the bulkhead of equipment. Use soapy water or P-80 Rubber Lubricant as needed.  
(Note: Loosen seal hardware only if required to seat it)
- \* Housing must be perpendicular/normal to the shaft.
- \* Mis-alignment of housing to shaft not to exceed 2°.
- Check for equal spacing around the shaft and the ID of the seal. Adjust as needed and then tighten mounting hardware to recommended torque setting of 18 ft. lbs

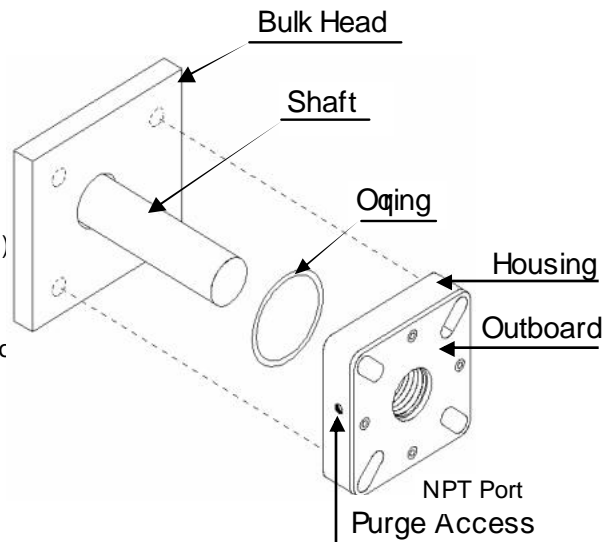

- **WARNING!!! Purge seal prior to operating.**
- **Purge options**  
Option 1: Air Purge using a Regulator.  
Option 2: Synthetic Grease, preferably Dow Corning G-4500

- **Option 1: Using Air Purge with regulator**  
Mount Regulator to Seal using appropriate fittings.  
2 ports for gauge are provided for convenience.  
Assembly gauge as desired & plug the unused port.

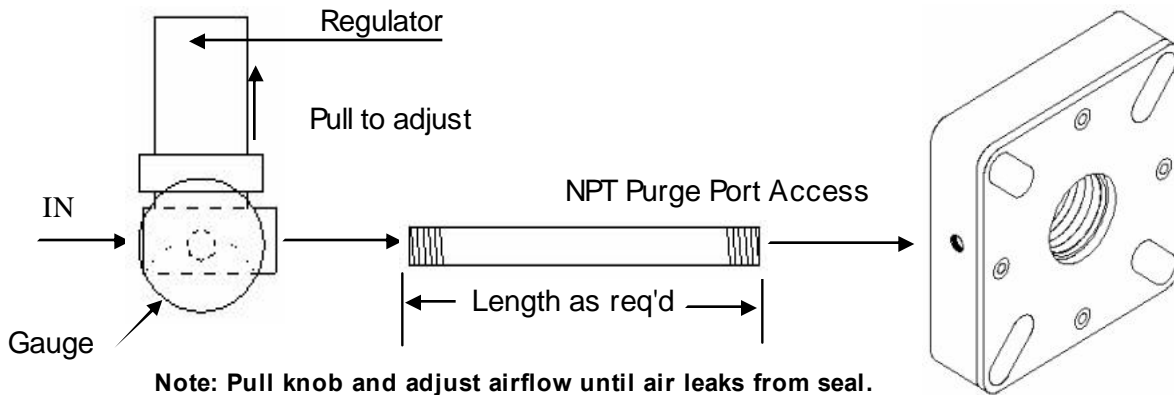

- **Option 2: Using Synthetic Grease**

NPT Purge Port Access  
Purge seal with grease until excess seeps out.  
Plug with appropriate fitting.

**\*Check weekly.**

